

Force Gauge PCE-DFG Load Cell (1 ... 10 kN)

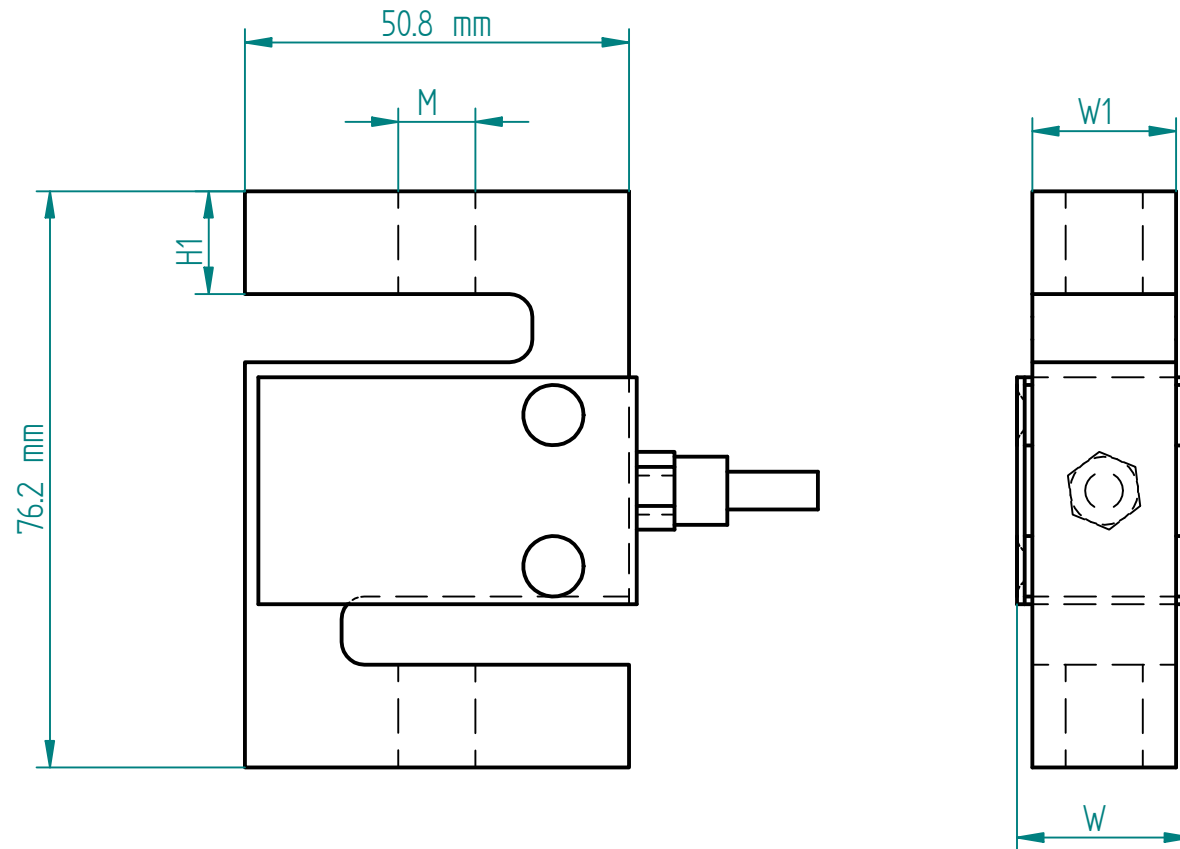

	W1 [mm]	W [mm]	H1 [mm]	M [mm]
1 kN	19	20.8	15.3	M10 x 1.5
2.5-5 kN	19	20.8	13.6	M12 x 1.5
10 kN	25.4	27.2	12.1	M12 x 1.75